

*Growing  
Together  
in  
Grace*  
*at Grace Lutheran School*



**Capital Improvement  
Campaign**





# GROWING TOGETHER IN GRACE PHASE 1 FACT SHEET



**Growing Together in Grace is a capital improvement project for Grace Lutheran School. Michael J. Burns Architects is assisting the school in addressing critical building needs.**

## Phase 1 includes:

- New geothermal heating and cooling
- Code compliant ventilation
- Air conditioning
- New pitched roof
- Replace exterior windows on six southernmost classrooms
- Replace north and south doors
- New ceilings and LED lighting
- Modern classroom improvements
- Add restroom on south end

Price tag in 2024 dollars: \$2.6 million

If properly funded, Phase 1 will begin **May 2024**.

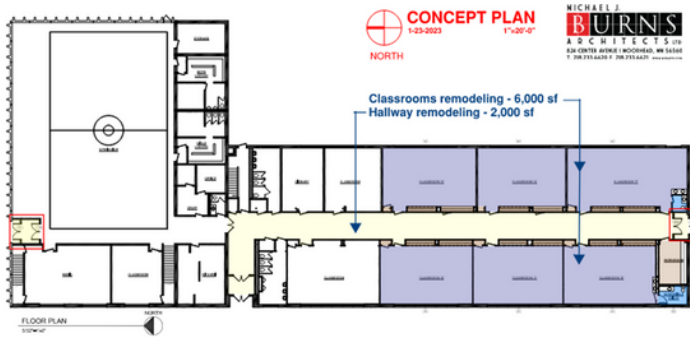

First Floor Remodel Plan



Interior Rendering of Classroom



Exterior Rendering of Pitched Roof  
(Back of Building)

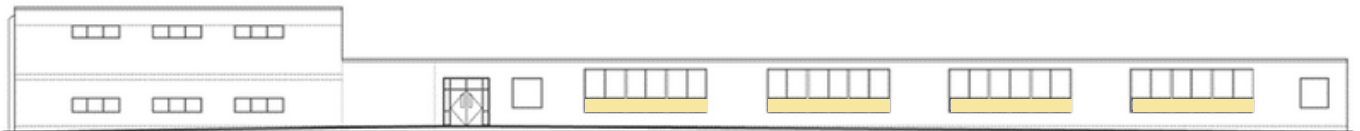

Current Elevation: Yellow areas indicate current windows.

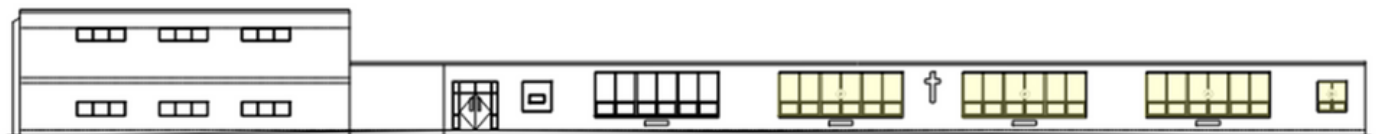

New Elevation: Yellow areas indicate new windows.



# GROWING TOGETHER IN GRACE

## PHASE 1 INTERIOR RENDERINGS



**Michael J. Burns Architects is designing the planned improvements at Grace Lutheran School. The Construction Committee is working to make specific space and finish decisions. The renderings below show some of the planned improvements.**



**Before:** Small windows, low ceilings with outdated lighting, plastic on windows to conserve heat.



**After:** Raised ceilings with new LED lighting, energy efficient large windows, updated finishes and storage.



**Before:** Mismatched flooring, open storage, underutilized storage space. Not pictured: air conditioning (none).



**After:** Updated, closed storage cabinets with a usable upper storage, matching floor finishes, and air conditioning!!



**BEFORE**



**AFTER**



# GROWING TOGETHER IN GRACE PHASE 2 FACT SHEET



**Growing Together in Grace is a capital improvement project for Grace Lutheran School. Michael J. Burns Architects is assisting the school in addressing critical building needs.**

## Phase 2 includes:

- Front entrance office suite with improved security
- Seven new classrooms (2 on main floor, five on second floor)
- Code-compliant restrooms
- Locker room renovations

Price tag in 2024 dollars: \$5.75 million

Phase 2 is planned so that almost no work in Phase 1 is undone. The Phase 2 timeline is 5-10 years in the future.



Above: Exterior Rendering of classroom addition on back of building.  
Below: Front Elevation

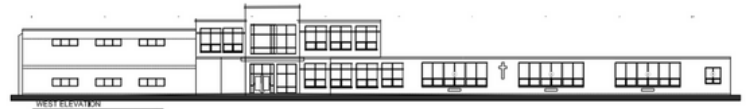

## The Future of Grace Lutheran School

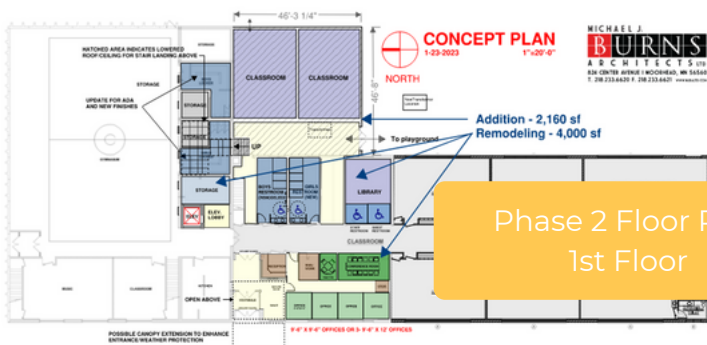

Phase 2 Floor Plan  
1st Floor

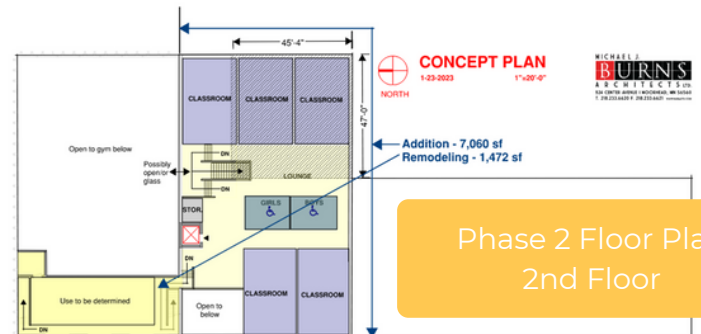

Phase 2 Floor Plan  
2nd Floor



# GROWING TOGETHER IN GRACE Q & A

**What is the purpose of the building improvement campaign, Growing Together In Grace?**

A recent building assessment determined that the physical building is in great condition, making a building renovation the most logical option for growth and improvement. Phase 1 of Growing Together in Grace takes care of many pressing needs, including improved building security, an up-to-date fire safety system, air conditioning, energy efficient heating, ventilation, replacement windows, and high quality classroom improvements. Phase 2 adds seven new classrooms, a new roof, and code-compliant restrooms.

**How much will the improvement campaign cost?**

Phase 1, in 2024 dollars, will cost \$2.6 million. Phase 2 has an estimated cost of about \$5.75 million.

**How much has to be raised and when?**

The fundraising goal is \$2.6 million. We have received enough pledges to begin the bidding process and to begin working out a construction timeline.

**What is the construction timeline for Phase 1 and Phase 2?**

Phase 1 construction would begin in Summer 2024. Phase 2 is still several years into the future, but our hope would be to start within five years.

**Who is managing funds for Growing Together in Grace?**

PACE, the financial support arm of Grace Lutheran School, is handling all donations. PACE has the resources and tools to accept many kinds of donations and handle the appropriate tax documentation.

**What is PACE?**

Partners Advancing Christian Education (PACE) is a financial organization established by supporters of Grace Lutheran School in the 1970s to raise funds, as the name suggests, to advance Christian education. While the organization has been operating quietly for many years, PACE is leading the fundraising effort for Growing Together in Grace.

**Can I send my donation directly to the school?**

Yes, donations can be sent directly to the school.

**I'm a member of a Red River Lutheran School Association church. Can I donate through my church?**

Yes, donors may choose how to route their funds, whether it's directly to PACE, through their church, or both.

**Can I donate stocks, bonds, a portion of my IRA, estate, property, or other financial product?**

PACE will ascertain which kinds of donations the campaign can receive. Specific questions will be relayed through the PACE Fundraising Committee and the PACE Board of Directors.



# WHAT MAKES GRACE DIFFERENT?

by Amy Hirsch

Fargo-Moorhead offers many school choices. What sets Grace apart?

In 2018, with an enrollment of just 53 students, Grace Lutheran School took a long, hard look at itself and decided that no matter our size, we were not giving up on our mission to provide Christian education in Fargo-Moorhead. God blessed our mission and perseverance, and today, Grace Lutheran School serves nearly 100 students.

Why is our school growing? What does the community see when they come to Grace Lutheran School?

First and foremost, we offer a truly Christ-centered education based on the unchanging Word of God. The world around us may change, but the Word of God endures and offers timeless answers to all modern-day challenges.

The Word of God infuses every single thing we do, every decision, every interaction, every outreach. The culture of our school is based entirely upon God's Word and His direction.

As a small school, it doesn't take too long to get a pulse on what's happening around the building. Without leaving my desk, I can hear children making music and singing about their Savior. I hear them thanking our cook, Miss Shirley, for the "best lunch ever." When I walk down the hall, I see two or three friends, arms slung across each others shoulders, walking to class.

I hear the Johnny Appleseed dinner prayer coming from the kindergarten classroom. I see a group of 5th grade girls surrounding their hurt friend in the gym. Hugs and high fives are infectious. Pre-Kindergarteners take off like race horses when they see their chapel buddies. If hugs had quotas we'd meet them every day.

I hear 3rd graders eating lunch, debating why it's a sin to be jealous of a friend's toy. I am asked, "May I please have some help with this?" and then thanked when we're done. I ask a 2nd grade student to tell me the story of Jonah and they remember all of it, even the city of Nineveh. I hear The Lord's Prayer resounding in 95 young voices every Wednesday at chapel.

A 6th grade student is listening to her Pre-K chapel buddy tell a story about their upcoming birthday party while playing checkers together. Our secretary is helping a 4th grade student with his math when two 8th grade students walk by with the flags to hang outside.

At the end of the day, as moms and dads mill about outside waiting for their students to be released, lifelong friendships are forged. It is a great comfort to find like-minded, Christ-centered families to share life's ups and downs.

Most poignant, though, is hearing the principal tell a 7th grade student that she is a perfect creation in God's eyes, that God is with her to help and guide her, and that she is surrounded by adults who love her as a unique child of God. Every child is deserving of knowledge of their Lord and Savior, Jesus Christ.

Sometimes the culture catches me off guard with its authenticity in a world in short supply. Grace Lutheran School's sole mission is to bring children to faith and strength in Jesus. There is no greater gift a parent can give to a child.

# Faith Promise Pledge Commitment



## Mission

Grace Lutheran School students receive a Christ-centered education, nurturing them in the knowledge of Jesus Christ, strengthening their faith in Jesus as Savior through the Word, inspiring them to respond with lives of Christian faith and service, and preparing them for citizenship and community.

## I want to grow with Grace!

- Helping Grace Lutheran School Grow**  
We're in! Here is our sacrificial commitment in partnership with Grace Lutheran School for the decades ahead through appropriate building and program enhancement.
- Growing in My/Our Own Grace of Giving**  
As God makes it possible through His blessing in my life, here is the best I can possibly do to help Grace Lutheran School through December 31, 2024. This is a faith promise, above and beyond what I could normally do – only possible as God makes it possible. It is my joyful intent – not a duty or an obligation - and both Grace Lutheran School / PACE and I understand that changing circumstances might prevent me from fulfilling these promises fully.

Phase 1

1-3 years

Initial Gift:

Cash/Check\* \_\_\_\_\_ Stocks \_\_\_\_\_ Bonds \_\_\_\_\_ Land \_\_\_\_\_  
\*Made out to PACE.

Other \_\_\_\_\_  
(Avoid capital gains taxes by donating appreciated assets directly to PACE.)

Pledge:

Total Amount of Pledge through December 20 \_\_\_\_\_

\_\_\_\_\_ per month, quarter, year (circle one) Other: \_\_\_\_\_

Total Number of Payments \_\_\_\_\_

Thrivent Choice Dollars \_\_\_\_\_ Other Match \_\_\_\_\_

In-Kind (professional services, trades, furnishing, equipment, etc)

Details: \_\_\_\_\_

I have included Grace Lutheran School in my will/estate planning.

Details: \_\_\_\_\_

Contact me about including Grace Lutheran School in my estate planning.

Total Commitment

My gift should remain anonymous.

Name \_\_\_\_\_

Address \_\_\_\_\_

Phone Number \_\_\_\_\_

Email \_\_\_\_\_

Signature & Date \_\_\_\_\_

*Therefore, as you received Christ Jesus the Lord, so walk in him, rooted and built up in him and established in the faith, just as you were taught, abounding in thanksgiving.*  
Colossians 2:6-7

Thank you

# Phase 2 Pledge



## Phase 2

As Grace Lutheran School pursues the long-term goal of growth and expansion, we invite you to extend your commitment to Phase 2 of the construction project's timeline in 2025-2033. Phase 2 adds seven modern classrooms, addresses security concerns, and paves the way for a long-desired high school.

Phase 2

years 3-10

Pledge:

Cash/Check \_\_\_\_\_ Stocks \_\_\_\_\_ Bonds \_\_\_\_\_ Land \_\_\_\_\_

Other \_\_\_\_\_  
(Avoid capital gains taxes by donating appreciated assets directly to PACE.)

Total Amount of Pledge 2025-2033 \_\_\_\_\_

\_\_\_\_\_ per month, quarter, year (circle one) Other: \_\_\_\_\_

Thrivent Choice Dollars \_\_\_\_\_ Other Match \_\_\_\_\_

In-Kind (professional services, trades, furnishing, equipment, etc)

Details: \_\_\_\_\_

I have included Grace Lutheran School in my will/estate planning.

Details: \_\_\_\_\_

Contact me about including Grace Lutheran School in my estate planning.

Total Commitment:

Grace Lutheran School is seeking partners for our Growing Together in Grace campaign. Who can you suggest?

Name

I Can Help

\_\_\_\_\_

\_\_\_\_\_

\_\_\_\_\_

\_\_\_\_\_

\_\_\_\_\_



*PACE (Partners Advancing Christian Education) is the financial support arm of Grace Lutheran School. Growing Together in Grace is organized under the direction of PACE. All gifts should be directed to PACE.*

*All gifts to Grace Lutheran School and PACE are tax deductible to the extent provided by law. Please consult your tax advisor. For income tax purposes, be advised you receive no goods or services in exchange for your contribution.*

*Grace Lutheran School and PACE are organized as 501(c)3 nonprofit corporations, and are exempt from federal tax liability by Internal Revenue Code Section 501(c)(3) and qualify as public charities under Internal Revenue Code Section 509.*

Thank you